

Type S - Surface Water Carrier Drains

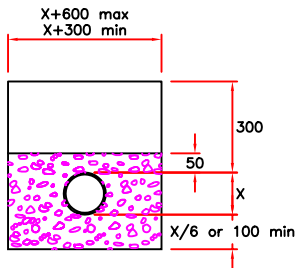

Type T - Surface Water Carrier Drains

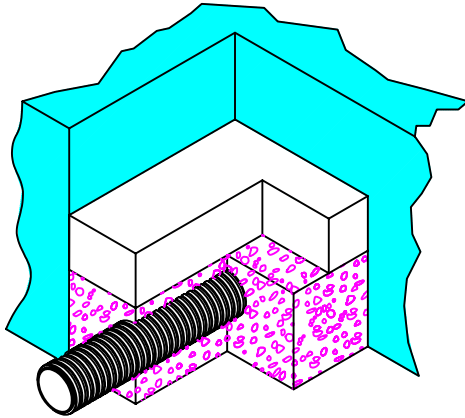
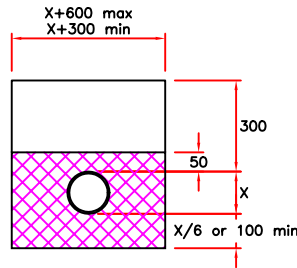
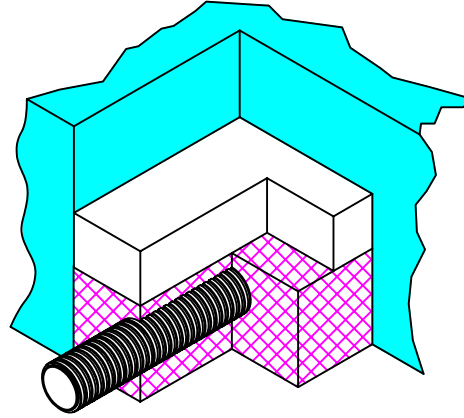

Type Z - Surface Water Carrier Drains

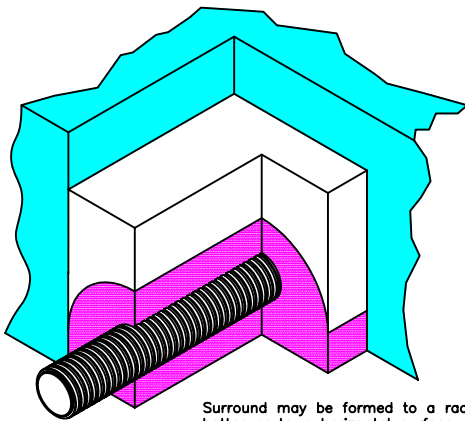

Surround may be formed to a radius batter or to a horizontal surface.

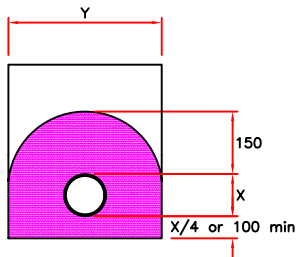

- Type S is the preferred granular bed and surround detail
- Type Z is recommended where depths of cover are less than 1.2metres. Joint filler board shall be placed in contact with the end of the socket at the pipe joint and shall extend through the full thickness of the concrete in contact with the pipe. These should be placed at each pipe joint.

- Class 8 material to S.H.W Clause 503.3 (iv)
- Concrete to S.H.W Clause 503.3 (iii)
- Granular material to S.H.W Clause 503.3 (i)
- Material to S.H.W Clause 503.3 (ii)
- In situ soil

S.H.W = Specification for Highway Works 2001 Edition

This information is for guidance purposes only. Please note that we may change the information from time to time, for a variety of reasons. This information cannot be relied upon to determine the suitability or installation requirements of our products for your particular site conditions or application: expert advice is required in this respect. Final determination of the suitability of any information or material for your intended use and manner of use is your sole responsibility and you must assume all risk and liability in this regard. This information is not intended to have any legal effect, whether by way of advice, representation or warranty. However, our technical staff will be happy to discuss your particular application and site conditions in further detail.

NOTES:

- 1.- All dimensions are nominal and in millimetres.
- 2.- This document is uncontrolled and updates will not be issued automatically.

Rev	Date	Description
-----	------	-------------

Scale	Not to Scale	
Drawn	IDA	30/04/02
Checked		
Approved		

RIDGIDRAIN
SURFACE WATER CARRIER
DRAIN
FOR HIGHWAY
APPLICATIONS

Polypipe Civils Ltd.
Civils & Agricultural Products

UNION WORKS, BISHOP MEADOW ROAD,
LOUGHBOROUGH, LEICESTERSHIRE, LE11 5RE.

CAD File: 16116D1.DWG	Polypipe Drawing No: TD/16116/D1	Rev
--------------------------	-------------------------------------	-----